

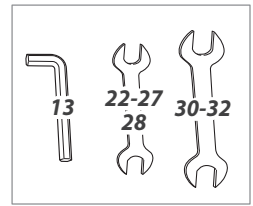

IZ

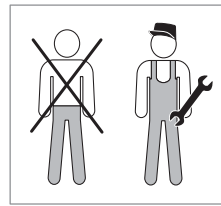

**Serie Tondera - Termostattizzabili e termostatiche - Thermostatizable and thermostatic**

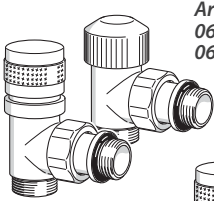

Art.  
0613 - 0633  
0610 - 0640

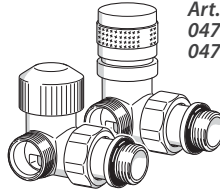

Art.  
0479 - 0619  
0477 - 0617

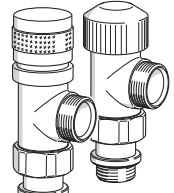

Art.  
0614 - 0634  
0611 - 0631

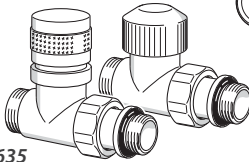

Art.  
0615 - 0635  
0612 - 0632

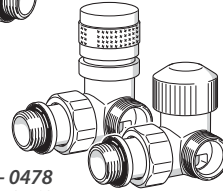

Art.  
0618 - 0478  
0616 - 0469



Art. 0481-E381

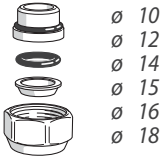

Art. 0483-E383

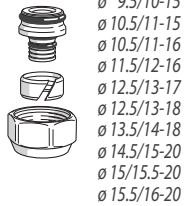

Art. 0490

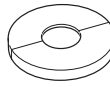

3/8"  
1/2"  
ø 10  
ø 12  
ø 14  
ø 15  
ø 16  
ø 18

Art. 0491

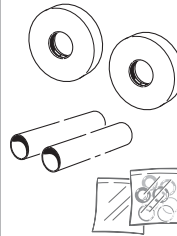

Art. 0093



Art. 0481-E381

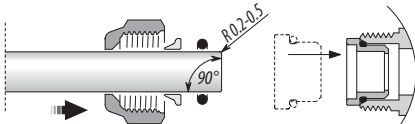

1

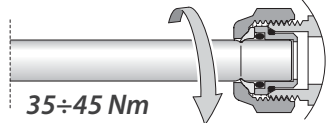

2

Art. 0483-E383

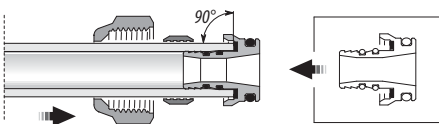

1

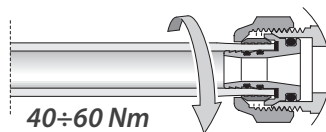

2



2 - 130°C (36-266°F)

Max 10 bar (145 psi)



Canapa - PTFE (Teflon) **1**  
Hemp - PTFE (Teflon)

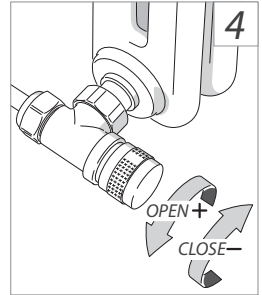
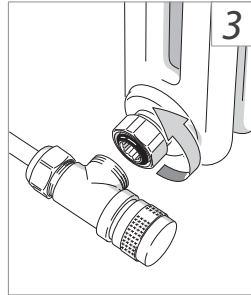
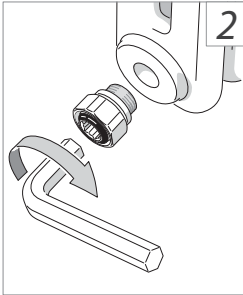
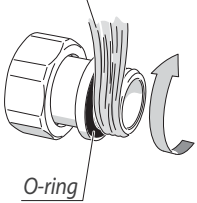

Art. 0093

